



Colours of LED's available.



Solum 4 Light Square

The Solum 4 Light LED unit has a stainless steel finishing detail with a 4mm + 4mm glass glazing, giving a walk over threshold of 500Kg. The standard LED's supplied are 4 x 1w 20 lumen White, with a total output of 80 Lumens and a 7w consumption.

The base unit is plastic for encapsulating into concrete with a pre-terminated cable exiting the Potted LED unit for connection to a 24v supply.

Other LED colours are available upon request.

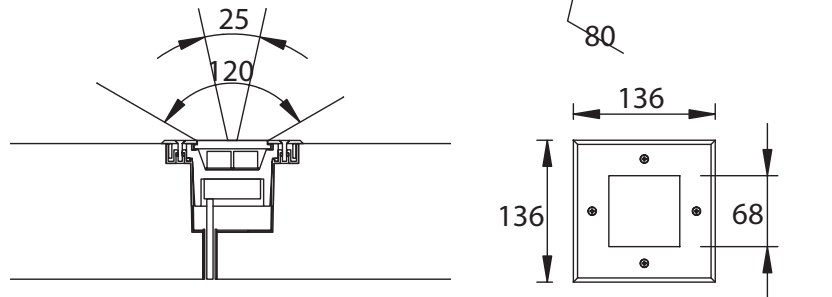

| | |
|-------------------|----------|
| LED Colour White | 80 Lumen |
| LED Colour Blue | 24 Lumen |
| LED Colour Red | 80 Lumen |
| LED Colour Yellow | 80 Lumen |
| LED Colour Green | 80 Lumen |

Product Features

The high output Solum LED units have the benefit of producing a focused beam of light for illuminating a variety of applications. Each LED (excluding blue) has an 80 lumen output, by multiplying the numbers within the luminaire then the output power increases. The units have a stainless steel surround that provides a modern low maintenance daytime appearance with the benefit of high output focused distribution for the night-time application. Having a 24v supply simplifies the installation and termination of these units.

Materials

The units have a polished stainless steel frame with glazing constructed of a 4mm + 4mm glass which will allow a walk over loading of 500Kg. The LED's are potted to prevent any water ingress with the unit being rated at IP67 and supplied complete with a plastic housing for encapsulating in concrete.

The individual units can be specified with fixed cable lengths, which greatly reduces the number of cable joints and improves the installation process, as only termination of each luminaire is required. Cable lengths must be specified when ordering.

Control Gear

For improved safety, and to simplify installation, the products have been rated at 24v, the installation would require a transformer for the supply, and cable lengths must be monitored. However the 24v system will simplify the routing of cables and the need to protect them is greatly reduced as they are low voltage.

Mains 230v-240v are available upon request. If the mains supply versions are preferred then it is important to realise that the need to protect the supply cables must be observed for operational and electrical safety.

© Sugg Lighting reserve the right to change the construction of their products without prior consultation. This ensures that product developments and continued improvements are maintained.



Sugg Lighting Limited

Sussex Manor Business Park

Gatwick Road

Crawley

West Sussex

RH10 9GD

England

Telephone: +44 (0)1293 540 111

Fax: +44 (0)1293 540 114

E-mail: sales@sugglighting.co.uk

www.sugglighting.co.uk





Solum 6 Light Round

The Solum 6 Light unit has a stainless steel finishing detail with a 4mm + 4mm glass glazing giving a walk over threshold of 500Kg. The standard LED's supplied are 6 x 1w 20 lumen White LED's, with a total output of 120 Lumens and a 11w consumption.

The base unit is plastic for encapsulating into concrete with a pre-terminated cable exiting the Potted LED unit for connection to a 24v supply. Other LED colours are available upon request.

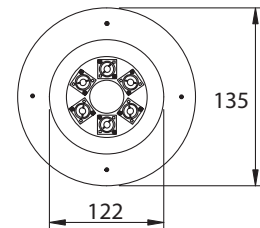
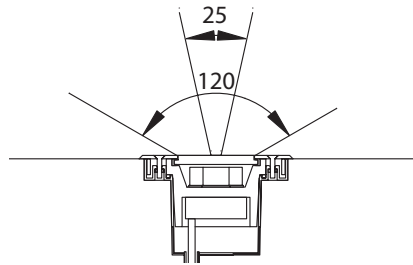
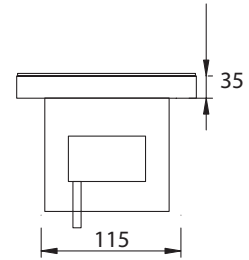

Solum 3 Light Round

The Solum 3 Light LED unit has a stainless steel finishing detail with a 4mm + 4mm glass glazing, giving a walk over threshold of 500Kg. The standard LED's supplied are 3 x 1w 20 lumen White LED's, with a total output of 60 Lumens and a 5w consumption.

The base unit is plastic for encapsulating into concrete with a pre-terminated cable exiting the Potted LED unit for connection to a 24v supply. Other LED colours are available upon request.

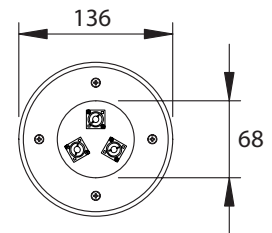
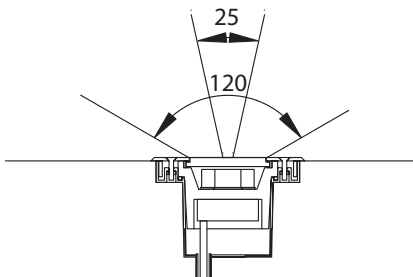
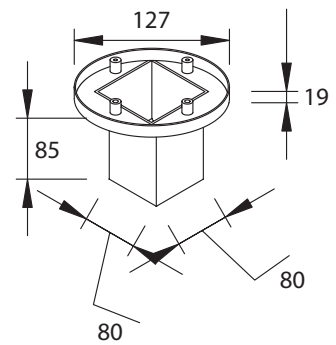

Solum 1 Light Round or Square

The Solum 1 Light LED unit has a stainless steel finishing detail with a 4mm + 4mm glass glazing giving a walk over threshold of 125Kg. The standard LED's supplied are 1 x 1w 20 Lumen White LED, giving a total of 20 Lumens and a 0.7w consumption. The base unit is spun aluminium for encapsulating into concrete with a pre-terminated cable exiting the Potted LED unit for connection to a 24v supply. Other LED colours are available upon request.

