



Product Features

The Mercian is a wall mounted, high performance, luminaire that is suitable for outdoor use in subways, precincts, building entrances, courtyards, parking areas, stairs and security areas. The prismatic control offered by the lens will produce eight times the mounting height spacings and give the performance required. The unit is manufactured from die-cast aluminium to provide strength and to dissipate heat which in turn will increase the life of the control gear. Suitable for HPS, HQI and TC-T lamps. The polycarbonate flame retardant, and impact resistant, lens provides the performance and security required with this type of fitting.

Features

The Mercian wall mounted luminaire is manufactured from LM6M aluminium alloy and finished in textured black. A diffused aluminium reflector ensures that maximum light output is achieved through the lens; the Mercian has integral gear. The front of the fitting hinges down to allow easy access for maintenance and lamp changing. This vandal resistant luminaire offers a performance wall mounted fitting to compliment building areas. The standard unit is supplied without a photocell as some wall mounting prevents the units clear sight to the sun.

Control Gear

The control gear is mounted within the fitting and thermal cutout protects the fitting from faulty lamps. The unit is able to house HPS, HQI and TC-T lamp types with a range of wattages. See table overleaf for details.



Sugg Lighting Limited

Sussex Manor Business Park

Gatwick Road

Crawley

West Sussex

RH10 9GD

England

Telephone: +44 (0)1293 540 111

Fax: +44 (0)1293 540 114

E-mail: sales@sugglighting.co.uk

www.sugglighting.co.uk

Options

Mounting Options

The unit is secured to the wall by a location bracket and then by a choice of drilling locations, depending on the surface.

Variations

Available with or without photocell. If a cell is required please specify. Tamper resistant cover screws are available upon request, as is an emergency version of this fitting. Please contact our sales office at the number below for current options and availability.

Materials

The body and frame are manufactured from LM6M aluminium alloy and finished in textured black. Flame proof and impact resistant prismatic polycarbonate lens.



Typical Specification

The Mercian wall mounted IP65 Luminaire: die-cast LM6M aluminium alloy body with a flame retardant, impact resistant, prismatic polycarbonate lens, that hinges open for access to gear and lamp. The luminaire measures 315mm wide, 335mm high, and projects from the wall by 190mm. The unit is secured by a bracket and two additional fixings at 285mm centres. Finished in textured black, supplied with **70w HPS-T** lamp with **E27** lamp holder and integral gear with a thermal cutout within the luminaire housing. Supplied with a one-piece electronic **Photocell** fitted into the luminaire body.

Photometric data is available upon request in various file formats, TM14, IES, and Philum,m.

Please note that items highlighted in bold can be changed using the options available.

Applications

The Mercian wall mounted luminaire is ideal for lighting walkways and pathways along the edges of buildings as the distribution provides a uniform lighting solution that will lace into an exterior car park design, which provides effective design solutions from the car park to building entrances. The Mercian will accommodate a range of lamps to blend with most design schemes.

Mercian Wall mounted luminaires at 3m Mounting height and spaced at 15m centres using a 57w CFL lamp achieves a 10 lux Eave and a Uo of 30% over a 6m area in front of the fittings.

6.1	6.0	10.2	19.8	30.3	28.4	15.6	7.8	5.6	7.4	14.7	27.3	29.7	20.5	10.8	6.1	5.9
6.7	6.3	12.4	19.4	16.7	19.7	16.5	9.6	5.0	9.2	15.9	21.7	16.8	19.9	13.0	6.7	6.3
6.8	6.7	6.5	10.4	6.5	6.5	10.2	7.6	6.5	7.5	10.0	7.0	6.5	9.4	6.8	6.8	6.7
4.8	4.7	5.4	4.2	3.2	3.2	5.1	5.1	4.7	5.1	5.4	3.1	3.2	4.1	5.5	4.8	4.7



Options

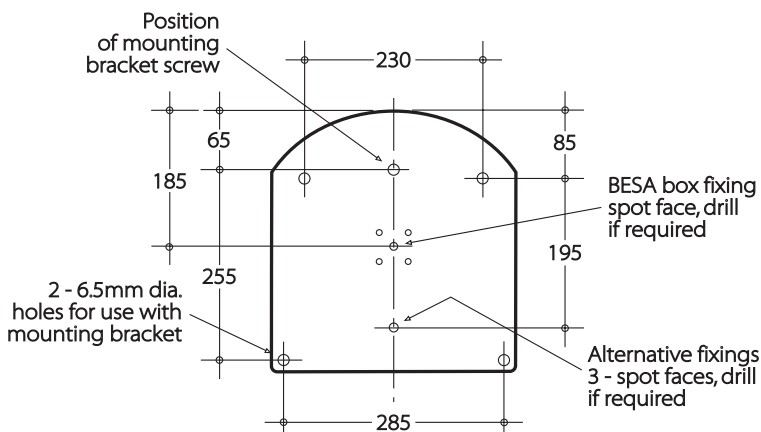
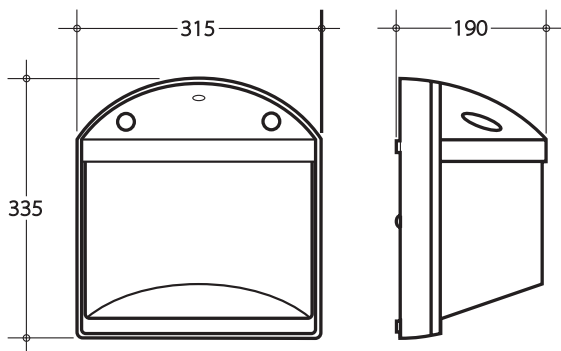

DIMENSIONS	
A Lantern Height	335mm
B Lamp Height	255mm
C Diameter/Width	315mm
E Standard Entry	n/a
F Frog Height	n/a
Weight	4Kg

GLAZING OPTIONS	
Polycarbonate	✓

WATTAGES & LAMP TYPES	35W	42W	50W	70W	KG
HPS			✓	✓	4.3
HQI	✓		✓	✓	4.3
TC-T		✓			2.8